



# PRODUCTS CATALOG

ELECTRICAL ENCLOSURES & MODULAR CABINETS



# 20

[exmweb.com](http://exmweb.com)

# NEMA 4-12 PUSHBUTTONS

# 1412 SD

## OIL & DUST TIGHT STANDARD PUSHBUTTON ENCLOSURES

The 1412 SD - 1412 ED - 1412 EL - 1412 MN - 1412 SF - oil and dust tight pushbutton enclosures are built to provide protection against dirt, dust and oil, for all brands of oil tight pushbuttons, switches and pilot lights. There are 6 types of enclosures, which are listed on the following pages. The 1412 series enclosures are made of high quality 16 GA steel, with all seams continuously welded. A high quality, seamless gasket, which is

poured in place, ensures a complete and durable seal of the enclosure. Cover screws thread into sealed wells and are captive. The enclosure can be internally or externally mounted using the included die cast wall mounting feet. These feet have oblong holes to facilitate installation. Hole plugs (880 HP series) are available to seal unused holes. The 1412 SD, 1412 ED and 1412 SF are also available with blank covers.

The 1412 EL enclosures come with a galvanized interior panel. Enclosures are finished with heat fused powder paint, electrostatically applied on a pre-treated base. Boxes are ANSI/ASA 61 smooth gray. Inner panel is galvanized (other colors available).

**CSA Certified / UL Listed  
NEMA/EEMAC 4-12 / IP66**

**Refer to p.734 to validate choice of substrate for the application**

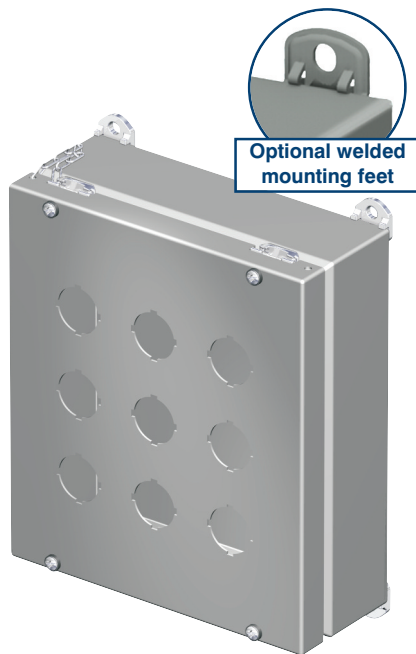
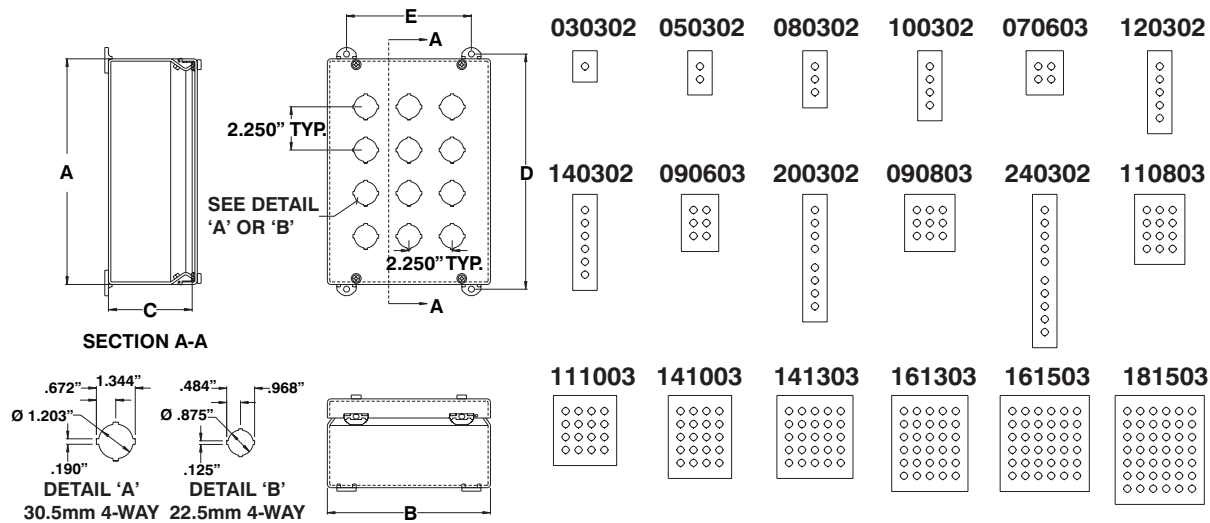

CATALOG NUMBER	QTY. HOLES	DIMENSIONS					SHIP WGT LBS.
		A	B	C	D	E	
1412 SD030302	1	4.000	3.500	3.000	4.500	2.375	1
1412 SD050302	2	6.250	3.500	3.000	6.750	2.375	2
1412 SD080302	3	8.500	3.500	3.000	9.000	2.375	3
1412 SD100302	4	10.750	3.500	3.000	11.250	2.375	4
1412 SD070603	4	7.750	6.500	3.000	8.250	5.375	4
1412 SD120302	5	13.000	3.500	3.000	13.500	2.375	5
1412 SD140302	6	15.250	3.500	3.000	15.750	2.375	6
1412 SD090603	6	10.000	6.500	3.000	10.500	5.375	5
1412 SD200302	8	20.750	3.500	3.000	21.250	2.375	7
1412 SD090803	9	10.000	8.750	3.000	10.500	7.625	7
1412 SD240302	10	25.250	3.500	3.000	25.750	2.375	8
1412 SD110803	12	12.250	8.750	3.000	12.750	7.625	8
1412 SD111003	16	12.250	11.000	3.000	12.750	9.875	9
1412 SD141003	20	14.500	11.000	3.000	15.000	9.875	11
1412 SD141303	25	14.500	13.250	3.000	15.000	12.125	13
1412 SD161303	30	16.750	13.250	3.000	17.250	12.125	14
1412 SD161503	36	16.750	15.500	3.000	16.250	14.375	16
1412 SD181503	42	19.000	15.500	3.000	19.500	14.375	18

**Notes :**

- Enclosures are also available with blank covers, add prefix 'C' to the catalog number (i.e. 1412 SDC070603).
- Enclosures are also available with 22.5mm pushbutton holes, add suffix 'MN' to the catalog number (i.e. 1412 SD070603MN).

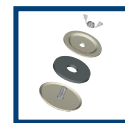

p.534

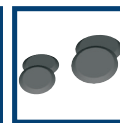

p.534



p.534